

# CITY OF NAPOLEON ZONING PERMIT APPLICATION

THIS APPLICATION IS FOR RESIDENTIAL DEMOLITIONS, FENCES, POOLS, SHEDS,  
DRIVEWAYS, SIDEWALKS & SEWERS

DATE \_\_\_\_\_ JOB LOCATION 1160 OHIO ST

OWNER Joe Moser TELEPHONE # 419-297-3392

OWNER ADDRESS 505 High St. Napoleon send permit.

CONTRACTOR Self/owner CELL PHONE # \_\_\_\_\_

DESCRIPTION OF WORK TO BE PERFORMED Storage building (no foundation)

---

ESTIMATED COMPLETION DATE ~~1000.00~~  
July 15th - 2015 ESTIMATED COST 1000.00

1-15-2015  
Shed

DESCRIPTION	FEE	TOTAL COST
Demo Permit	(100.3100.46690)	\$
Fence	\$25.00	\$
Pool	\$25.00	\$
Garage and Shed Under 200 SF (Detached)	\$25.00	\$ <u>25.00</u>
Driveway	0	\$
Sidewalk/Curbing	0	\$
Sewer Outside	0	\$
<b>Subtotal:</b>		\$
		\$
<b>TOTAL FEE:</b>		\$ <u>25.00</u>

**I FULLY UNDERSTAND THAT NO EXCAVATION, CONSTRUCTION OR STRUCTURAL ALTERATION, ELECTRICAL OR MECHANICAL INSTALLATION OR ALTERATION OF ANY BUILDING STRUCTURE, SIGN, OR PART THEREOF AND NO USE OF THE ABOVE SHALL BE UNDERTAKEN OR PERFORMED UNTIL THE PERMIT APPLIED FOR HEREIN HAS BEEN APPROVED AND ISSUED BY THE CITY OF NAPOLEON BUILDING/ZONING DEPARTMENT.**

*I hereby certify that I am the Owner of the named property, or that the proposed work is authorized by the Owner of record and that I have been authorized by the Owner to make this application as his/her authorized agent and I agree to conform to all applicable laws of the jurisdiction. In addition, if a permit for Work described in this application is issued, I certify that the code official or the code official's authorized representative shall have the authority to enter areas covered by such permit at any reasonable hour to enforce the provisions of the code(s) applicable to such permit.*

**I HEREBY ACKNOWLEDGE THAT I HAVE READ AND FULLY UNDERSTAND THE ABOVE LISTED INSTRUCTIONS.**

SIGNATURE OF APPLICANT: Joe Moser DATE: \_\_\_\_\_

PRINT NAME: Joe Moser

---

BATCH # 32125 CHECK # cash DATE 5/22/15

SHEFFIELD ST

OHIO ST.

NTS

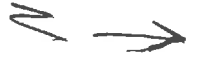

HOUSE  
1160 OHIO ST

GARAGE

Proposed 10x16  
Storage barn

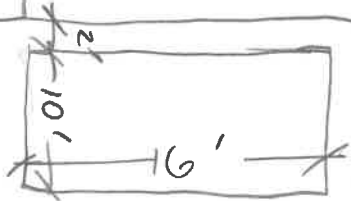

ALLEY